

### Marquee point mounting - 201



glass/wall fixation

Stainless steel design

Art.no.	glass	
44.0201.010.12	10 - 17,52 mm	1

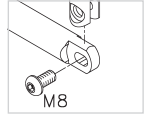
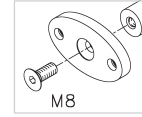
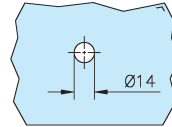
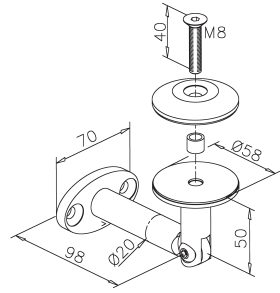

### Marquee point mounting - 202



glass connector

Stainless steel design

Art.no.	glass	
44.0202.010.12	10 - 17,52 mm	1

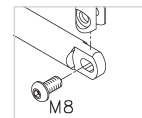
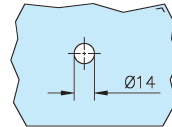
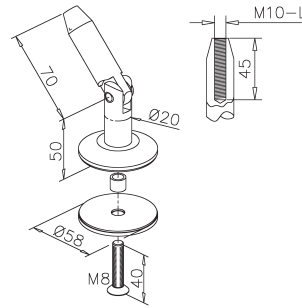

### Marquee point mounting - 203



wall connector

Stainless steel design

Art.no.		
44.0203.010.12		1

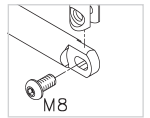
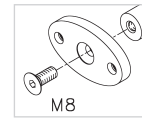
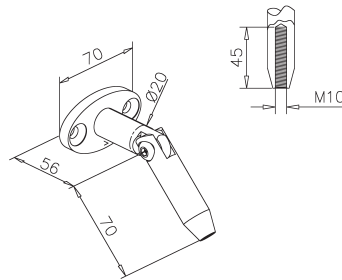

### Wall mounting plate - 280



Stainless steel design

Art.no.		
44.0280.100.12		1

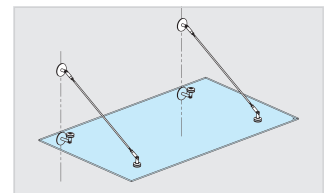
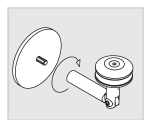
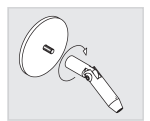
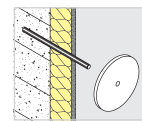
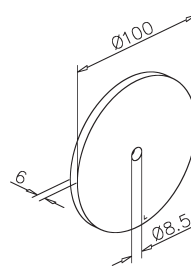

### Rod - 299



with thread M10, left/right

Stainless steel design

Art.no.	L
44.0282.010.12	842 mm
44.0299.010.12	cutted

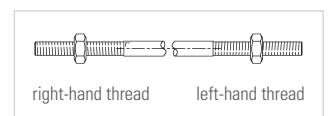
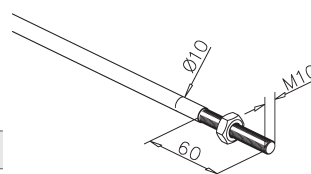

INFO 44.0201...

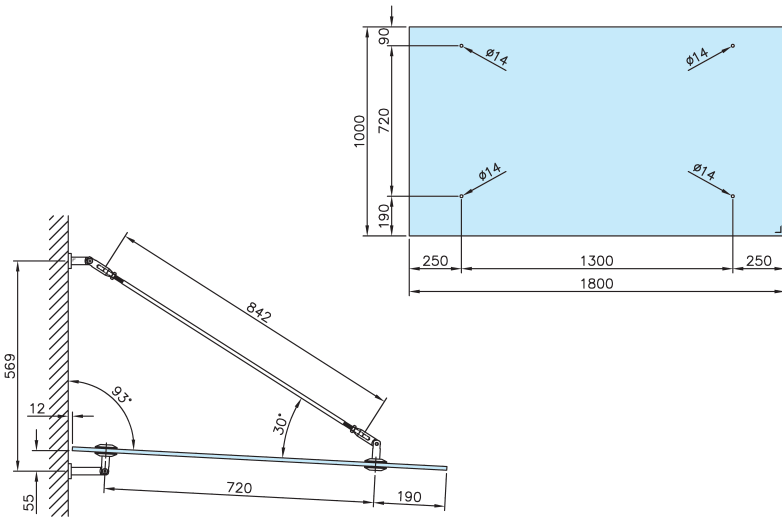
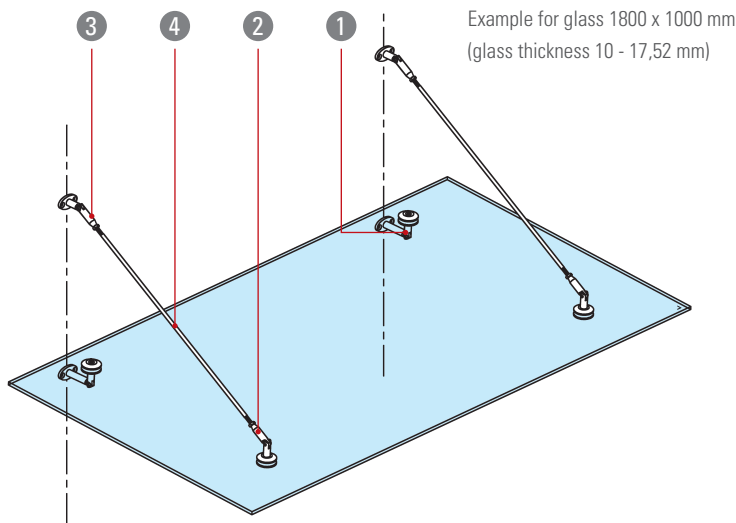

1 44.0201.010.12

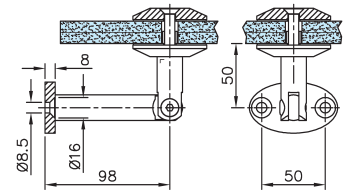

2 44.0202.010.12

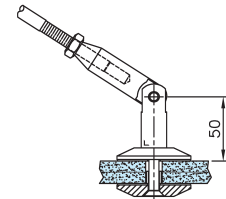

3 44.0203.010.12

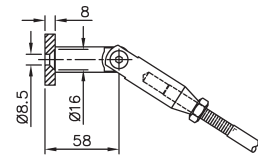

4 44.0282.010.12

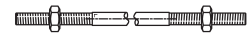

right-hand thread      left-hand thread



Glass-marquee - 2010



Stainless steel design

Art.no.

29.2010.010.12

INFO Products



2 x  
44.0201.010.12



2 x  
44.0202.010.12



2 x  
44.0203.010.12



2 x  
44.0282.010.12